



Ihr Partner für E-Learning und Kompetenzmanagement

# Flexible User-Management- and Single-Sign-On-Service

Peter Grünwald, bureau42 GmbH ([peter.gruenwald@bureau42.de](mailto:peter.gruenwald@bureau42.de))

Roland Klemke, Open Universiteit Nederland ([roland.klemke@ou.nl](mailto:roland.klemke@ou.nl))

bureau42 GmbH

Goebenstraße 10 - 12

D-50672 Köln

Tel: +49 (0) 221 277 995 - 0

Fax: +49 (0) 221 277 995 - 11

[www.bureau42.de](http://www.bureau42.de)

[info@bureau42.de](mailto:info@bureau42.de)

Ein Unternehmen der Humance AG



Centre for Learning Sciences and Technologies  
[celstec.org](http://celstec.org)

Aachen, 20.10.2008

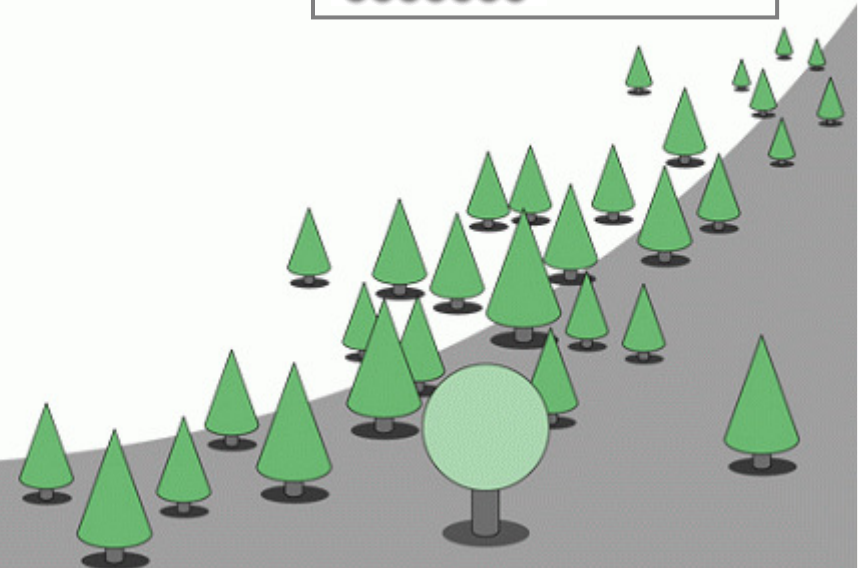

# Agenda

- ▶ Company Information bureau42
- ▶ Product Information author42
- ▶ User Management and Single Sign On Service
  - ▶ Description
  - ▶ Requirements
- ▶ Live Demonstration



# Company Information

- bureau42 -



## Foundation:

Gründung im Juni 2002

Spin-Off des Fraunhofer Instituts FIT

Preisträger Gründerwettbewerb Multimedia des  
Bundeswirtschaftsministers 2002

Seit Herbst 2005: 100%-Tochter der Humance AG



## Core business:

Technologien und Dienstleistungen für E-Learning mit besonderem  
Schwerpunkt bei authoring-Technologien

Verzahnung organisatorischer Prozesse und innovativer Technologien zu  
ganzheitlichen Ansätzen

## Management:

Dr. Roland Klemke (Dipl.-Inf.)

Philipp Kröpelin (M.A. Politik, Phil., Geschichte)

## Location:

Köln



humance\*



Centre for Learning Sciences and Technologies  
celstec.org



# Product Information

## - author42 -

► What is author42?

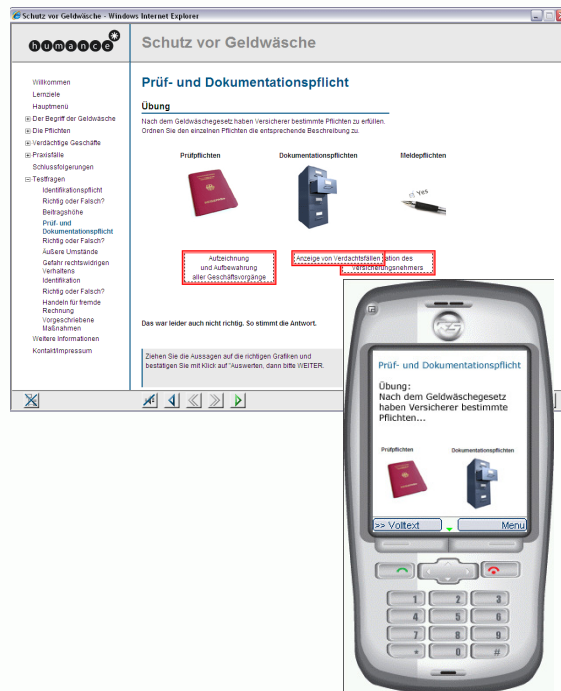

# The Project

## - User Management and Single Sign On Service -

- ▶ Motivation: author42 – 5.0
  - ▶ Modern, service-oriented architecture
  - ▶ Open-Source-Technologies
  - ▶ State-of-the-art User-Interface-Technologies
  
- ▶ Process: Reimplementation of core components in a service-based manner in order to
  - ▶ be technologically state of the art
  - ▶ be architecturally open
  - ▶ be based on open source technologies
  - ▶ be flexible in implementation and deployment
  
- ▶ Your Task
  - ▶ Creation of a User Management and Single Sign On Service



# The project

## - Requirements: Non Functional -

- ▶ Based on open source technologies
- ▶ Java EE including glassfish application server (aka sun application server 9.1)
- ▶ SSO component: CAS, OpenSSO, JOSSO
- ▶ Flexible, css-based user interface design
- ▶ User data backend store (e.g. based on ldap)
- ▶ Web-based front ends using ajax
- ▶ Web service api

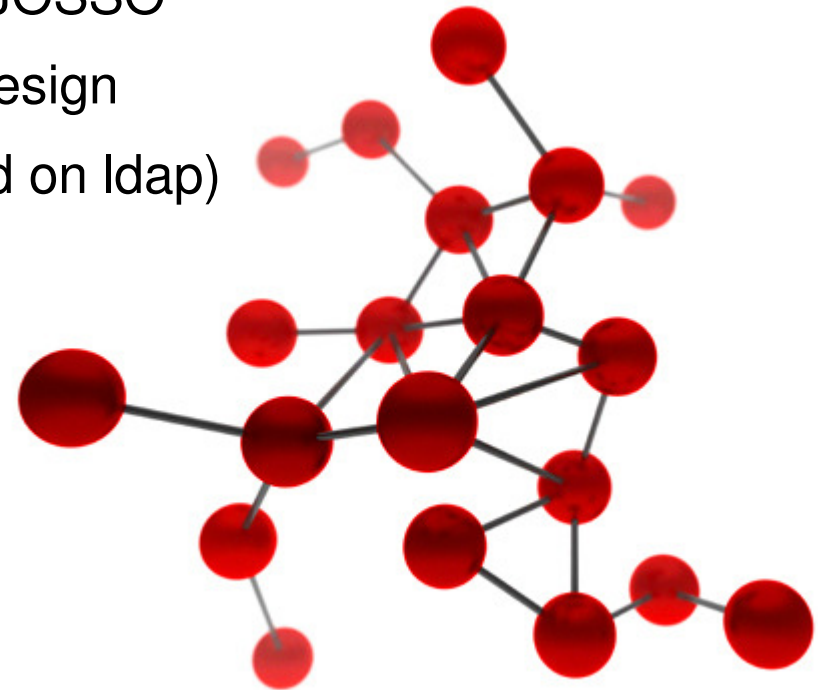

# The project

## - Requirements: User Management -

- ▶ User self registration front end
  - ▶ Registration process
  - ▶ with optional email confirmation process
- ▶ user profile front end (user self management)
- ▶ admin user management front end
  - ▶ registration of users
  - ▶ user data bulk import (e.g. from csv, Idif)
- ▶ assignments of roles and rights
- ▶ optional definition of guest user accounts



## The project

### - Requirements: Role/Right Management -

- ▶ admin interface for role/right specification
- ▶ assignement of roles and rights to users
- ▶ default assignement for self registrated users
- ▶ default assignement for guest users





## The project

### - Requirements: Single Sign On Service -

- ▶ different web-service applications form an application environment
- ▶ shared login-/logout-process
- ▶ session management
- ▶ support for different SSO standards



# Das Projekt

## - Kompetenzen -

- ▶ Developer
  - ▶ Database Design
  - ▶ Object-Oriented Design & Implementation
  - ▶ Development of Webservices
  - ▶ Web-based user interfaces based on AJAX, etc.
  
- ▶ User Interface Designer
  - ▶ Flexible Graphical Design
  - ▶ Usability





*Ihr Partner für E-Learning und Kompetenzmanagement*

**Thank you!**

**Questions?**

